

HOW TO FIT... SUFFOLK LATCH



1.

Position the latch at the required height on the gate, normally at the height of the gate cross strut.



2.

Measure 50mm from the leading edge of the gate and mark a vertical line 38mm long. Cut a 38 x 10mm slot through the gate on this line.



3.

Pass the lever from the thumb latch through the slot ensuring it can be fully raised and lowered.

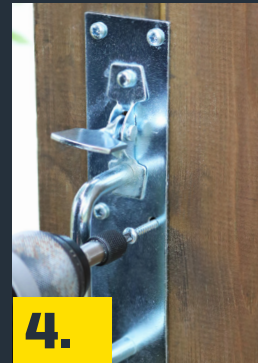

4.

Mark the fixing holes of the thumb latch back plate, drill pilot holes and fix with screws provided.

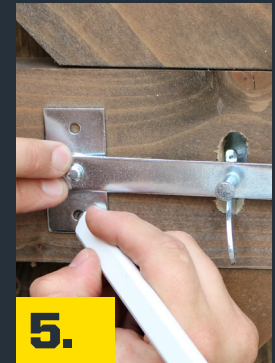

5.

Position the latch bar on the rear of the gate style above the thumb lever so that is level when the lever is down and overlaps the gate post by at least 35mm. Mark the fixing holes of the latch bar.

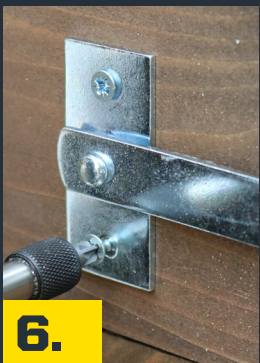

6.

Drill pilot holes and fix with screws provided.



7.

Position the keep on the post so that the latch bar sits in the notch of the keep when closed. Mark the fixing holes of the keep, drill pilot holes and fix with screws provided.



8.

Slide the jump staple over the latch bar and position on the gate level with the keep and ensuring the latch bar can fully engage and release.



9.

Mark the fixing holes of the jump staple and fix with screws provided.

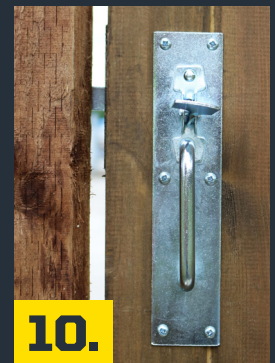

10.

Check gate / door opens and shuts without any catching.